

Centerdrill R Type Radial

The R Type Centerdrill is a combined drill and countersink, used where the most precise centering accuracy is required. The tip form features a curved contour to enable a single band of contact. This radial tip distributes forces evenly during drilling.

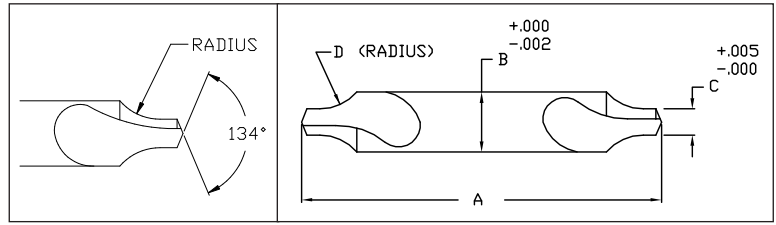

Drill Type	Part No.							OAL (A)	Body DIA (B)	Drill DIA (C)	Radius (D)
	HSS	HSS-TiN	HSS-TiAlN	HSS-LH	COBALT	COBALT-TiN	COBALT-TiAlN				
OOR	10-L2-000	-	-	-	-	-	-	1-1/4	1/8	.025	.1175
OR	10-L2-001	-	-	11-L2-001	10-CO-001	-	-			1/32	.1358
1R	10-L2-002	-	-	11-L2-002	10-CO-002	-	-			3/64	.136
1R3	10-L2-023	-	-	11-L2-023	-	-	3				
1R4	10-L2-024	-	-	11-L2-024	-	-	4				
1R5	10-L2-025	-	-	11-L2-025	-	-	5				
1R6	10-L2-026	-	-	-	-	-	6				
2R	10-L2-003	10-TN-003	10-TL-003	11-L2-003	10-CO-003	CO-TN-003	CO-TL-003	1-7/8	3/16		
2R4	10-L2-027	-	-	11-L2-027	-	-	-	4			
2R5	10-L2-028	-	-	11-L2-028	-	-	-	5			
2R6	10-L2-029	-	-	-	-	-	-	6			
3R	10-L2-004	10-TN-004	10-TL-004	11-L2-004	10-CO-004	CO-TN-004	CO-TL-004	2	1/4	7/64	.207
3R4	10-L2-030	-	-	11-L2-030	-	-	-	4			
3R5	10-L2-031	-	-	11-L2-031	-	-	-	5			
3R6	10-L2-032	-	-	11-L2-032	-	-	-	6			
4R	10-L2-005	10-TN-005	10-TL-005	11-L2-005	10-CO-005	CO-TN-005	CO-TL-005	2-1/8	5/16	1/8	.248
4R4	10-L2-033	-	-	11-L2-033	-	-	-	4			
4R5	10-L2-034	-	-	11-L2-034	-	-	-	5			
4R6	10-L2-035	-	-	11-L2-035	-	-	-	6			
45R	10-L2-049	-	-	-	-	-	-	2-1/2	3/8	9/64	.279
45R4	10-L2-036	-	-	11-L2-036	-	-	-	4			
45R5	10-L2-037	-	-	11-L2-037	-	-	-	5			
45R6	10-L2-038	-	-	11-L2-038	-	-	-	6			
5R	10-L2-006	10-TN-006	10-TL-006	11-L2-006	10-CO-006	CO-TN-006	CO-TL-006	2-3/4	7/16	3/16	.323
5R5	10-L2-039	-	-	11-L2-039	-	-	-	5			
5R6	10-L2-040	-	-	11-L2-040	-	-	-	6			
6R	10-L2-007	10-TN-007	10-TL-007	11-L2-007	10-CO-007	CO-TN-007	CO-TL-007	3	1/2	7/32	.407
6R5	10-L2-041	-	-	11-L2-041	-	-	-	5			
6R6	10-L2-042	-	-	11-L2-042	-	-	-	6			
7R	10-L2-008	10-TN-008	10-TL-008	11-L2-008	10-CO-008	CO-TN-008	CO-TL-008	3-1/4	5/8	1/4	.593
7R6	10-L2-043	-	-	11-L2-043	-	-	-	6			
8R	10-L2-009	10-TN-009	10-TL-009	11-L2-009	10-CO-009	CO-TN-009	CO-TL-009	3-1/2	3/4	5/16	.663
8R6	10-L2-044	-	-	11-L2-044	-	-	-	6			

