

Centerdrill ST Type 60° (Metric)

Same as our ST Type 60° Centerdrill, now available in standard metric sizes in both HSS and Cobalt.

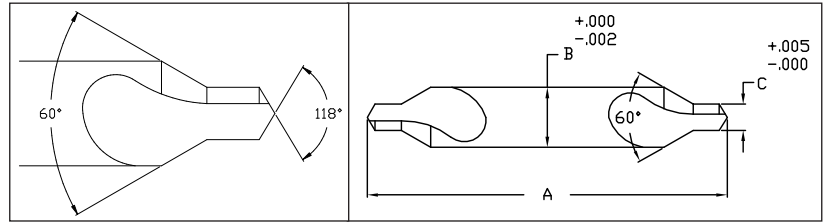

Drill Size	Part No.						OAL (A)	Body DIA (B)	Drill DIA (C)
	HSS	HSS-TiN	HSS-TiAlN	COBALT	COBALT-TiN	COBALT-TiAlN			
1.0 X 3.15	23-L2-004	23-TN-004	23-TL-004	23-CO-004	CO-TN-010	CO-TL-010	31.5	3.15	1.00
1.25 X 3.15	23-L2-005	23-TN-005	23-TL-005	23-CO-005	CO-TN-011	CO-TL-011	31.5	3.15	1.25
1.6 X 4.0	23-L2-006	23-TN-006	23-TL-006	23-CO-006	CO-TN-012	CO-TL-012	35.5	4.00	1.60
2.0 X 5.0	23-L2-007	23-TN-007	23-TL-007	23-CO-007	CO-TN-013	CO-TL-013	40.0	5.00	2.00
2.5 X 6.3	23-L2-008	23-TN-008	23-TL-008	23-CO-008	CO-TN-014	CO-TL-014	45.0	6.30	2.50
3.15 X 8.0	23-L2-009	23-TN-009	23-TL-009	23-CO-009	CO-TN-015	CO-TL-015	50.0	8.00	3.15
4.0 X 10.0	23-L2-010	23-TN-010	23-TL-010	23-CO-010	CO-TN-016	CO-TL-016	56.0	10.00	4.00
5.0 X 12.5	23-L2-011	23-TN-011	23-TL-011	23-CO-011	CO-TN-017	CO-TL-017	63.0	12.50	5.00
6.3 X 16.0	23-L2-012	23-TN-012	23-TL-012	23-CO-012	CO-TN-018	CO-TL-018	71.0	16.00	6.30
8.0 X 20.0	23-L2-013	23-TN-013	23-TL-013	23-CO-013	CO-TN-019	CO-TL-019	80.0	20.00	8.00